



201<sup>ST</sup> ANNUAL  
**Convention**  
OF THE SWEDENBORGIAN CHURCH

Spiritual Innovation  
for a Changing World



The Year of the New Jerusalem  
(2025–2026)

PORTLAND STATE UNIVERSITY  
PORTLAND, OREGON  
JUNE 26 – JULY 1, 2025

# Contents

President’s Greeting ..... 4

Convention Schedule ..... 5

Mini Course Listing ..... 8

Keynote Address..... 15

Worship Services ..... 16

Outings & Banquet..... 17

Things You May Need to Know ..... 18

Virtual Voting ..... 19

Thank You Donors..... 20

Acknowledgments ..... 21

Maps & Addresses ..... 22

Ministry Milestones ..... 23

# President's Greeting

Dear Friends (in-person and virtually),

Welcome to Convention 2025, our 201<sup>st</sup> Annual Session of the Swedenborgian Church of North America. We are pleased to hold our multi-generational in-person program again in a conference hotel environment adjacent to a major university and to support in a robust fashion our virtual attendees.

We have journeyed through the Year of the Word with its profound insights into the foundations of how divine love and wisdom are always communicating the power of spiritual living to us, and with joy and vision we enter the Year of the New Jerusalem, the singular symbol and vision point distinguishing the Swedenborgian movement. We are delighted to be continuing our “convention” of an annual gathering where we will share what’s going on in our many organizations, conduct necessary business, explore energizing educational opportunities, enjoy delightful outing options, and celebrate the beauty and power of our purpose as God’s servants.

May all these times of work and play help us be a better church and grow the community of our very distinctive and exceptional Church.

—*Rev. Dr. Jim Lawrence*

President,  
Swedenborgian Church of North America

# Convention Schedule

All times listed are Pacific Time.

All events listed with a ✓ will be offered in a hybrid format for virtual attendees.

## Pre-Convention Program

THURSDAY, JUNE 26, 2025

<b>3:00–5:00</b>	Check-In for COM	<i>University Place Hotel</i>
<b>6:00–7:00</b>	Dinner	<i>Hotel Dining Area</i>
<b>7:00–9:00</b>	COM Welcome Reception	<i>Pool Courtyard</i>

FRIDAY, JUNE 27, 2025

<b>6:30–8:30</b>	Hotel Breakfast	<i>Hotel Dining Area</i>
<b>9:00–12:00</b>	COM Business Meeting I ✓	<i>Willamette Falls</i>
<b>12:00–1:00</b>	Lunch	<i>Hotel Dining Area</i>
<b>1:00–3:00</b>	COM Educational Meeting ✓	<i>Willamette Falls</i>
<b>3:00–5:00</b>	COM Business Meeting II ✓	<i>Willamette Falls</i>
<i>—Snacks sponsored by the Massachusetts New Church Union</i>		

## Convention Program

FRIDAY, JUNE 27, 2025

<b>1:00–4:00</b>	Display Table Set-Up	<i>Columbia Falls</i>
<b>2:00–5:00</b>	Convention Check-In	<i>University Place Hotel</i>
<b>3:00–5:00</b>	Casual Welcome Gathering	<i>Pool Courtyard</i>
<i>—Sponsored by Marquette Associates</i>		
<b>5:00–5:45</b>	Convention Worship Singers Practice*	<i>Coos Bay Room</i>
<b>6:00–7:00</b>	Dinner	<i>Willamette Falls</i>
<b>7:00–7:30</b>	Opening Convention & Worship ✓	<i>Columbia Falls</i>
<b>7:30–9:00</b>	Keynote Speaker ✓	<i>Columbia Falls</i>
<b>9:00–10:00</b>	Reception & Displays Open	<i>Columbia Falls</i>

*\*For those who are interested in singing in the Convention Worship Singers choir, please come to the first practice. A practice schedule will be created at this time for the rest of Convention.*

## SATURDAY, JUNE 28, 2025

<b>6:30–9:00</b>	Hotel Breakfast	<i>Hotel Dining Area</i>
<b>9:00–11:30</b>	Business Session I ✓	<i>Columbia Falls</i>
<b>12:00–1:00</b>	Lunch	<i>Willamette Falls</i>
<b>1:00–2:30</b>	Mini Course Session I ✓	<i>University Place Hotel**</i>
<b>2:45–4:45</b>	Business Session II ✓	<i>Columbia Falls</i>
<b>5:00–6:00</b>	SCCM Meeting ✓	<i>Columbia Falls</i>
<b>6:00–7:00</b>	Dinner	<i>Willamette Falls</i>
<b>7:00–8:30</b>	Convention Worship & Communion ✓	<i>Columbia Falls</i>
<b>8:30–9:30</b>	Reception & Displays Open	<i>Columbia Falls</i>

## SUNDAY, JUNE 29, 2025

<b>6:30–9:00</b>	Hotel Breakfast	<i>Hotel Dining Area</i>
<b>8:00–8:45</b>	Service of Remembrance ✓	<i>Columbia Falls</i>
<b>9:00–11:30</b>	Business Session III ✓	<i>Columbia Fall</i>
<b>12:00–1:00</b>	Lunch	<i>Willamette Falls</i>
<b>1:00–2:30</b>	Mini Course Session 2 ✓	<i>University Place Hotel**</i>
<b>2:45–3:15</b>	Business Session IV ✓	<i>Columbia Falls</i>
<b>3:15–4:00</b>	CSS Annual Meeting ✓	<i>Columbia Fall</i>
<b>4:00–5:00</b>	Display Tables Open	<i>Columbia Falls</i>
<b>5:00–6:00</b>	Dinner	<i>Willamette Falls</i>
<b>7:30–8:00</b>	Travel to St. James Church	<i>In front of University Place Hotel</i>
<b>8:00–10:00</b>	Ordination Service & Reception —Sponsored by the Center for Swedenborgian Studies	<i>St. James Church</i>
<b>10:00</b>	Travel Back to Campus	<i>St. James Church</i>

*\*\*Please see the Mini Course listing for the room assignments for each Mini Course. There is a map of each floor on page 22.*

MONDAY, JUNE 30, 2025

<b>6:30–9:00</b>	Hotel Breakfast	<i>Hotel Dining Area</i>
<b>9:30–10:15</b>	SCYL Worship Service	<i>Columbia Falls</i>
<b>10:30–12:00</b>	Mini Course Session 3 ✓	<i>University Place Hotel**</i>
<b>12:00–1:00</b>	Lunch	<i>Willamette Falls</i>

***Display Tables MUST be broken down by 2:00 PM***

<b>2:00–2:30</b>	Transportation to Outings	<i>In front of University Place Hotel</i>
<b>2:30–5:30</b>	Three Outings	
	-International Rose Test Garden	
	-Pittock Mansion	
	-Powell's City of Books	
	— <i>Sponsored by the Pacific Coast Association</i>	
<b>5:30</b>	Travel Back to Campus	
<b>6:00–9:00</b>	Closing Banquet	<i>Columbia Falls</i>

TUESDAY, JULY 1, 2025

<b>6:30–9:00</b>	Hotel Breakfast	<i>Hotel Dining Area</i>
<b>11:00</b>	<b>Everyone MUST Check-out by 11:00 AM</b>	

# Mini Courses

Mini Courses are small group offerings for attendees (both virtual and in-person) to learn about a topic that is presented by someone from the Swedenborgian Church of North America, or an invited guest.

There are two formats for Mini Courses this year:

- In-person Mini Course
- Hybrid Style Mini Courses. People will be able to participate both in-person and online together using Zoom Events.

Each time slot has four courses running concurrently, two in-person and two hybrid. All Mini Courses will be located in the University Place Hotel.

## MINI COURSE TIME SLOT 1 – SATURDAY, JUNE 28 AT 1:00 PM

Created in the Image of God: Imago Dei and D.E.I.

**with Dr. Rebecca Esterson in the Pyramid Lake Room**

*This course will be in-person on campus.*

This session will explore resonances between our contemporary discourses about Diversity, Equity, and Inclusion and the ancient notion of Imago Dei. Christian theologians have historically used Genesis 1:27 as a starting point for understanding the nature of divinity in relation to humanity. That “God created humankind in his own image” became known by the Latin shorthand Imago Dei and used this as a framework for discerning ways that the human form—in body and spirit—reflects God’s form. Our Swedenborgian theology celebrates the diversity of human forms in light of Imago Dei, paving the way for an embrace the fullest possible inclusion in our communities and institutions. “Perfection comes from variety even in heaven” (*Heaven and Hell* §56)

**Dr. Rebecca K. Esterson** is the Dean of the Center for Swedenborgian Studies and the Dorothea Harvey Professor of Swedenborgian Studies. She teaches in the Department of Sacred Texts and Their Interpretation at the Graduate Theological Union in Berkeley, and is a member of the Swedenborg Society of the East Bay.

## Spiritual Boundaries in Relationships

**with Rev. Alison Moore in the Columbia Falls Ballroom**

*This course will be in-person on campus.*

Swedenborgian Psychotherapist Mark Carlson has identified inner or Spiritual boundaries, which he calls “Microboundaries.” When we learn and understand where and why these boundaries exist and stop crossing them with others, our relationships, both professional and personal, will improve. There

are boundaries related both to our Will and our Understanding, and they matter. Come learn about them and possibly deepen your understanding of what they are, why they matter, and how knowing about them can transform your relationships.

**Rev. Alison Longstaff Moore** was raised in the General Church but left that denomination to become ordained by the Swedenborgian Church of North America when she was 44. She has served as an assistant at the Church of the Good Shepherd, Canada, and as Pastor in Bath, Maine. Now at 63, she is delighted to be working again in full time ministry as the Pastor at the Church of the Good Shepherd in Kitchener, Canada.

## All is Within: The Internal Sense of the Writings with Rev. Thom Muller in the Crater Lake Room

*This course will be hybrid for both in-person and remote attendees.*

“Do the writings have an inner meaning?”

Since the beginning of our movement, there have been countless approaches to reading the theological works of Swedenborg, from literal, to esoteric, to critical, to literary and psychological interpretations.

While Swedenborg is commonly understood to be quite clear about the existence and supremacy of the internal sense of the “Word,” and the correspondential nature of the spiritual world (and reality as a whole), many of us, including within the tradition’s liberal theological factions, have historically had a tendency to primarily focus on a literal, metaphysical reading of the writings themselves.

This Mini Course will explore the perspective that the theological works of Emanuel Swedenborg contain a continuous inner, spiritual, or correspondential meaning, which both supports and supersedes the literal, and provides us with unprecedented insight into the nature of God, our own psyche, and our regenerative journey.

We will also bring this approach into dialogue with the current times and explore how an esoteric reading of Swedenborg’s theological works can help us engage some commonly challenged aspects of his teachings in light of contemporary insights into science, theology, philosophy, and history.

**Rev. Thom Muller** is pastor at the Swedenborgian Society of the East Bay at Hillside, an Urban Sanctuary, in El Cerrito, California, as well as senior editor of *Our Daily Bread*. His passions include the intersection of spirituality and psychology, interfaith theology, and the Western esoteric tradition. Native of Germany, he was ordained into the ministry of the Swedenborgian Church of North America in 2016, upon receiving his theological education at Bryn Athyn College and the Pacific School of Religion in Berkeley, California.

# Building a Successful Hybrid Ministry

**with Rudy Caseres in the Astoria Room**

*This course will be hybrid for both in-person and remote attendees.*

Hybrid church services are incredibly difficult to implement. Often technology goes wrong and online participants feel like they are getting a back-seat experience. Learn how to get over these hurdles and what audio/visual tech your church should implement to achieve a successful hybrid or fully digital ministry.

**Rudy Caseres** is the Digital Communications Manager for the Swedenborgian Church of North America. This will be his third Annual Convention serving as audio/visual technical director. He has recently worked in-person with Wayfarers Chapel's Exploring New Earth digital ministry and upgraded Fryeburg New Church's hybrid services. His goal is to teach member churches what he has learned from these experiences.

## MINI COURSE TIME SLOT 2 – SUNDAY, JUNE 29 AT 1:00 PM

### What are the Main Differences of the Swedenborgian Beliefs from Mainline Christianity, and Why?

**with Rev. Junchol Lee in the Pyramid Lake Room**

*This course will be in-person on campus.*

In this Mini Course, I would like to explore and point out what makes the Swedenborgian belief uniquely different from other religious beliefs, and even other Christian denominations, and thus makes it as an antidote to many poisons from shortcomings of Christianity, and ancient religions in general. One expectation is that after this Mini Course, people may be able to answer the age-old simple question, "How are you different?"

**Rev. Junchol Lee:** After his ordination in July, 2000, Junchol served on many committees of the General Convention including Executive Committee of Council of Ministers (six years), Ministry Support Unit (three years), Committee of Admission into Ministry (seven years), the General Council (one year), and served SCYL as the Youth Chaplain for seven terms. Also, Junchol offered Mini Courses at Convention for many years, and delivered lectures at the Almont Summer Camp. Junchol is deeply interested in the spiritual aspect of education for all Swedenborgians, and finding ways to connect people with the teachings of Emanuel Swedenborg. Currently, Junchol is serving the San Francisco Swedenborgian Church as Senior Pastor.

## The Labyrinth as a Spiritual Praxis with Dr. Dylan Odhner in the Columbia Falls Ballroom

*This course will be in-person on campus.*

Course Description: Experience the labyrinth as a tool for spiritual reflection and renewal. This course combines history, symbolism, and hands-on practice, featuring both an open-walk and a guided “Tour of the Holy City New Jerusalem” Audio-Journey. Step onto this ancient path and explore how movement, meditation, and Swedenborgian insights can deepen your spiritual practice.

*Dr. Dylan Odhner is a seasoned educator with extensive experience teaching at the high school, college, and graduate levels. His passion for fostering intellectual curiosity and critical thinking reaches beyond the classroom to educational travel planning, curriculum development, and the designing of sacred spaces. He is the founder of Golden-Thread Labyrinths, a unique venture specializing in designing, building, and facilitating mission-focused meditation labyrinths, and labyrinth activities.*

## Swedenborg, Alchemy, and Activism: Life of an American Philosopher-Soldier with Rev. Dr. Jim Lawrence and Michael Goos in the Crater Lake Room

*This course will be hybrid for both in-person and remote attendees.*

Ethan Allen Hitchcock was a mid-19th century U.S. Army General, an activist for Native American rights, and a self-taught philosopher who developed an original interpretation of Swedenborg and Alchemy. He lived through some of the most challenging moments of United States history, carefully documenting his own thoughts and emotions through his practice of journaling, as he deconstructed America’s imperialism from within that imperialism’s most instrumental institution.

His unwavering allegiance to justice earned him great respect among the Native American communities where he sought to eliminate fraud committed by exploitative Euro-Americans. Later in life, he was present during one of the country’s darkest moments, coming out of retirement at Abraham Lincoln’s request during the Civil War, and, when Lincoln was assassinated, staying by the body for several days.

Reading Hitchcock’s work not only opens one up to a uniquely positioned perspective on historical events, but through his theoretical writings, introduces valuable comparative studies of Swedenborg and other neglected spiritual thinkers, culminating in a vision of reality that is rational and transcendental, reflecting Hitchcock’s personal context as a descendant of revolutionary war hero and deist philosopher Ethan Allen, and as a participant in a much older dialogue discussing the relation between truth, symbolism, and esotericism.

We invite everyone who is interested to join the Mini Course and learn more about this fascinating historical figure!

**Rev. Dr. Jim Lawrence** is President of the Swedenborgian Church of North America and scholar of Swedenborgian history and spirituality.

**Michael Goos** is a student at the Center for Swedenborgian Studies, an ordinand with General Convention, and a recipient of the Nunc Licet scholarship who is deeply grateful to be a member of the Swedenborgian community. In addition to pursuing the ministry, Michael aspires to lift-up neglected Swedenborgian figures from history.

## Glorification: An Overview

**with Rev. Dr. Gard Perry in the Astoria Room**

*This course will be hybrid for both in-person and remote attendees.*

The aim of this Mini Course is to bring Swedenborg's treatment of the glorification within reach of our understanding. There are four topics: 1) Swedenborg's summary of the process; 2) problem statement and solution; 3) a brief biography of the historical Jesus; and 4) Swedenborg's spiritual psychology.

Swedenborg's summary is from True Christianity; George Dole identified a problem of interpretation and a solution with his meta translation method; the biography of the historical Jesus builds on current scholarly consensus; and spiritual psychology is framed as "a search for truth with an aim to deepen our love for the Lord and for the neighbor."

Swedenborg's glorification summary will sound familiar, though things get difficult when we turn to his step-by-step process in the Arcana (aka, Secrets of Heaven). Large words like celestial, spiritual, and natural have multiple levels of meaning in various contexts. That prompted George Dole to apply a meta translation method of interpretation—employed here to discover what the glorification sounds like to our 21st Century lived experience. A key finding is that Swedenborg's treatment of the glorification can reach our understanding as the capacity for a deeper kind of empathy.

**Rev. Dr. Gard Perry** has engaged the sections of Swedenborg's Latin text that treat the Lord's glorification for more than two decades and offers a summary of his findings in this Mini Course. Gard began his Swedenborgian life as a child at the Fryeburg New Church Assembly (FNCA) and has come full circle to be an FNCA senior lecturer. Gard has served on numerous boards and committees, currently serving on the Board of Trustees of the Center for Swedenborgian Studies, the Tafel Fund, and Council of Ministers. Gard's aim is to cultivate a practice of research and development for a 21st Century understanding and application of Swedenborgian ideas.

Tools for Healing the Pain of Polarization  
with **Rev. Roslyn Taylor in the Columbia Falls Ballroom**

*This course will be in-person on campus.*

Most people would agree that we are living in very divisive times, around the world. Many of us are suffering from personal losses due to polarization and the relationship fractures that can result from an “us versus them” mentality, whatever the context. Rooted in Swedenborgian teachings, this Mini Course explores two tools to use as pathways to bridge divides and restoring relationships. Through drawing on our Divinely given human potentials, we can begin to heal the pain of our polarization on many levels.

***Rev. Roslyn Taylor** is a minister with the Swedenborgian Church of North America, living in Bryn Athyn, Pennsylvania. She has been the spiritual leader of the Home Church in Bryn Athyn since 2003. She was the editor of a volume of essays by Swedenborgian authors, published in 2005 as *Healing Words: A Sampler of Wholeness Theology*. More recently, she founded the *Deborah's Tree* ministry in 2021, which promotes the work of female Swedenborgian scholars, writers, clergy, and artists. Rev. Taylor has been active in the *Gathering Leaves* retreats for Swedenborgian/New Church women since 2004 and is currently chairing the *Steering Committee for Gathering Leaves 2025*.*

Paul: The Difficult Apostle  
with **Dell J. Rose in the Pyramid Lake Room**

*This course will be in-person on campus.*

Paul of Tarsus was one of the most complex and influential thinkers of all time. He was the main influence in spearheading the Jesus-Movement's transition from another Jewish messianic sect to the most successful religion of all time, Christianity. However, the dominance of his thought has also obscured the multiplicity of Christian interpretations, Swedenborg's included. Swedenborg struggled with the legacy of the difficult apostle, his ubiquity, and his qualifications 'to speak for the Lord.' In this seminar we will consider Swedenborg's critiques of Paul by highlighting the personal similarities they shared, and how both struggled to put into a system their own personal experiences of the Lord. To see Paul and Swedenborg as two travelers down the same metaphoric highway, I hope to shift the focus to the rhetorical strategies that each used to convey their teachings and reduce Paul's status as the primary exponent of the Gospel. It is hoped that by presenting this material it will give Swedenborgians the ability to engage other Protestant movements who center Paul's understanding of the Christ event and to effectively engage with them.

***Dell J. Rose** is program director at the Swedenborg Library Chicago and is Swedenborg Society (UK) Doctoral candidate at the Centre for the History of Hermetic Philosophy at the University of Amsterdam. His eclectic intellectual interests focus on the interplay between elite culture and esoteric spiritual currents in several different social and political contexts. At present, he is working on a monograph focusing on Swedenborgianism in Meiji Japan (2026), and his dissertation considers Swedenborgian political movements across the globe. His publications include studies of Southcottianism, British Israelism, the nascent history of the Bahá'í faith, as well as Old Norse and Welsh legal history.*

## Meditation for Children

**with Sarah Wood Vallely in the Crater Lake Room**

*This course will be hybrid for both in-person and remote attendees.*

Sarah is offering a special Mini Course designed for adults who want to teach meditation to children. In this course, you'll explore the brain science behind mindfulness and its many benefits, gain a deeper understanding of how meditation supports children's emotional and social development, and learn how to strengthen your own mindfulness practice. Plus, you'll discover what kids love about meditation—and what challenges they may face—so you can better support them on their journey.

*Sarah Wood Vallely has been teaching meditation to children for over twenty years and training teachers, parents, and therapists to do the same. Her training programs have reached people all over the world, and she has written two books: *Sensational Meditation for Children* and *The Magic Gum Tree*. Sarah is offering a special Mini Course designed for adults who want to teach meditation to children. In this course, you'll explore the brain science behind mindfulness and its many benefits, gain a deeper understanding of how meditation supports children's emotional and social development, and learn how to strengthen your own mindfulness practice. Plus, you'll discover what kids love about meditation—and what challenges they may face—so you can better support them on their journey.*

## Honoring Historic Sacred Spaces: Restoration and Evolution

**with Rev. Shada Sullivan in the Astoria Room**

*This course will be hybrid for both in-person and remote attendees.*

The Church of the Holy City in Wilmington Delaware is one of the oldest Swedenborgian churches in the United States. It has a fascinating history, and it continues to hold space for a vibrant congregation and evolving uses. Historic buildings need intentional and ongoing care, which takes time and resources. This Mini Course will discuss the history of The Church of the Holy City, its

current uses, and knowledge gained from its restoration journey, which includes being a recipient of a prestigious National Fund for Sacred Places challenge grant.

***Rev. Shada Sullivan** has been the Pastor at The Church of the Holy City in Wilmington Delaware since 2017. She is a founding member of the leadership team of Swedenborgians in Action Against Racism, and is co-chair of the SCNA Social Justice Committee. Rev. Shada grew up in The New Church in Australia, and has been living in the United States since 1994. She has two daughters, one of whom recently graduated from college.*

## Keynote Address

"Spiritual Innovation for a Changing World:  
The New Church Vision"

WITH REV. RICH TAFEL

FRIDAY, JUNE 27 AT 7:00 PM PT

*This event will be hybrid for both in-person and remote attendees  
from the Columbia Falls Ballroom.*

Rich Tafel is a Swedenborgian pastor, bridge-builder, and thought leader dedicated to healing divides in our society through spiritual insight and practical action.

As pastor of Church of the Holy City in Washington, DC, and a graduate of Harvard Divinity School, Rev. Tafel has spent his life bringing people together across political, religious, and cultural lines. He developed the Cultural Translator training to help leaders navigate conflict and build coalitions rooted in deeper understanding.

In both his ministry and public life, Rich integrates faith with service, having worked in government, education, and global health. He also is the co-founder of initiatives that connect social impact investing with real-world change.

Rev. Tafel continues to teach, speak, and lead at the intersection of spirituality, public leadership, and civic renewal—living out a Swedenborgian call to serve the common good through love and wisdom in action. He also is the chair of the Council of Ministers.

# Worship Services

We hope that you can join us for worship during Convention this year! For your convenience the services, times, locations, and officiants are listed below.

- ♦ **Opening Worship** with Rev. Junchol Lee,  
Columbia Falls Ballroom, Friday at 7:00 PM
- ♦ **Convention Worship and Communion** with Rev. Kevin Baxter,  
Columbia Falls Ballroom, Saturday at 7:00 PM
- ♦ **Service of Remembrance** with Rev. Kit Billings &  
Rev. Renée Machiniak, Columbia Falls Ballroom, Sunday at 8:00 AM
- ♦ **Ordination Service** with Rev. Dr. Jim Lawrence & Chelsea Ohdner,  
St. James Church, Sunday at 8:00 PM  
*\*St. James Lutheran Church is a mile away from campus.  
Please meet outside the hotel at 7:30 for transportation.*
- ♦ **Swedenborgian Church Youth League (SCYL) Worship Service**  
with the SCYL attendees at Convention, Columbia Falls Ballroom,  
Monday at 9:30 AM



## 2025 Convention Photo Album

*Please share your photos here for all to see and for us to use in  
the Messenger, Swedenborg.org, and other online platforms!*

# Outings

## THREE DESTINATIONS TO CHOOSE FROM

MONDAY, JUNE 30 FROM 2:00–5:30 PM

*Please meet outside the hotel at 2:00 for transportation.*

This year, you have the opportunity to choose from three unique outings—each offering a different glimpse into the charm and character of Portland, Oregon. Whether you're a lover of nature, history, or literature, there's something for everyone:

### INTERNATIONAL ROSE TEST GARDEN

Stroll through a stunning display of over 10,000 rose bushes in bloom at one of Portland's most iconic attractions. Located in Washington Park, this garden offers a peaceful retreat with breathtaking views of Mt. Hood and downtown Portland.

### PITTOCK MANSION

Step into Portland's past with a guided visit to the historic Pittock Mansion. Built in 1914, this beautifully preserved estate sits high above the city and offers a fascinating look at the life and legacy of one of Portland's founding families.

### POWELL'S CITY OF BOOKS

Get lost in the stacks at the world's largest independent bookstore. Spanning an entire city block, Powell's is a haven for book lovers and a true Portland institution. Take your time browsing thousands of titles and don't forget to stop by the Rare Book Room

## CLOSING BANQUET IN THE COLUMBIA FALLS BALLROOM AT THE UNIVERSITY PLACE HOTEL

MONDAY, JUNE 30 FROM 6:00–9:00 PM

We will enjoy a meal prepared by the chefs entitled "A Taste of Portland," a celebration of recognitions, and enjoy the stylings of a live DJ!

# Things You May Need to Know

## **Contact Information:**

If you are staying at the hotel, please contact the front desk for any issues related to your room or stay. For Convention help, go to [swedenborg.org](http://swedenborg.org) and click the **Convention Help Button** at the top of the page to contact the help desk. **To reach Central Office, you can text or call 857-217-3309.**

## **Parking:**

Parking is available for an additional charge and guests must register their vehicle with the Front Desk before parking in the surrounding lot. Parking is \$3/hour or \$13/day. Hotel guests receive their Parking Pass at the Front Desk for \$13/day. Visitors receive parking from Kiosks in the Parking Lot or through the Parking Kitty App (Code: 81878).

## **Recreation Center:**

Hotel guests get exclusive non-student entrance to PSU's world class Academic & Student Recreation Center, located just six blocks, or two MAX stops from the hotel. Located at: 210 Academic & Student Recreation Center (ASRC) 1800 SW 6th Avenue, Floors 2–4. A \$15 day pass includes access to a two-court gymnasium, a 1/11 mile, three lane running track, a synthetic floor gymnasium equipped with dasher boards for floor hockey and indoor soccer, a large vascular and weight training facility, two multi-purpose group fitness suites, an aquatic complex including a lap pool and whirlpool spa, locker rooms, a bouldering wall, and daily fitness classes.

## **Public Computers & Printers:**

Unfortunately, there are no public computers that are available for use. There is a FedEx location if you need to print locally at 221 SW Alder St., Portland Oregon, or bring your own if needed.

## **WiFi:**

WiFi access is available. Password will be provided upon arrival. You must agree to comply with the hotel's internet usage policies to use their network.

## **Check-out Information:**

Check-out is at 11:00 AM. Please return your key to the front desk and take care of your bill. There is a complimentary Continental Breakfast available from 6:30 – 9:00 AM.

# Virtual Voting

If you are a delegate you will be using NemoVote to vote and should have been sent a voter registration email after virtual registration closed. It is a separate voting service and requires you to have a separate registration with their service. You will go to your account on NemoVote to make your choices and submit your votes. If you are attending in-person you can use a smart phone to vote. If you do not have a smart phone we will have a device available for you to use. There will also be someone available to help you if you are having difficulties with the system.

## NEMOVOTE QUICK GUIDE

### *To log in:*

- Go to <https://swedenborg.nemovote.com>
  - Or Follow the link you received in your email
- Type in your username (your email address) and password (included in the activation email)
- Click “Login”



**NemoVote Log In**

### *To vote:*

- NemoVote homepage should be the current votes available to you
- If not, click “My Votes” in the upper left
- Click the blue ballot box icon in the “Actions” column to open your ballot
- Follow the screen prompts to make your voting selections
- Votes CANNOT be redone so double check your selections carefully
- Click “Submit Vote” and follow prompt instructions
- Make sure you complete all the votes. There will be a second page of votes for elections.
- To learn about the 2025 nominees and amendments please go to: [swedenborg.org/events-activities/annual-convention/](https://swedenborg.org/events-activities/annual-convention/)
- If you wish to write-in a candidate for any position please email: [writeinvote@swedenborg.org](mailto:writeinvote@swedenborg.org)
- If you need assistance, go to [swedenborg.org](https://swedenborg.org) and click the Convention Help Button at the top of the page to contact the help desk.

# Thank You for Your Support!

Thank you to the following for donations towards,  
Convention Programming, Music, Technology, and Youth Programs.

## DONATIONS:

- ◆ Peggy Andrews
- ◆ Rev. Kit Billings
- ◆ Pastor Linda Callander
- ◆ Devon Carberry
- ◆ Karen Conger
- ◆ Pastor Paul Deming
- ◆ The Garden Church
- ◆ Michael Goos
- ◆ The Gray Fund
- ◆ Rev. Youngmin Kim
- ◆ Korean New Church
- ◆ Rev. Catherine Lauber
- ◆ Rev. Dr. Jim Lawrence
- ◆ Jennifer Lindsay
- ◆ Rev. Renée Machiniak
- ◆ Marquette Associates
- ◆ Massachusetts  
New Church Union
- ◆ Pastor Connie McOsker
- ◆ Pastor Gordon Meyer
- ◆ New York Association
- ◆ Deborah O'Reilly
- ◆ Pacific Coast Association
- ◆ Malcolm Peck
- ◆ Rev. Dr. Gard Perry
- ◆ Portland New Church
- ◆ Pretty Prairie  
New Jerusalem Church
- ◆ Karen Scott
- ◆ Kim Shine
- ◆ Rev. Shada Sullivan
- ◆ The Tafel Fund
- ◆ Church of the Holy City,  
Washington, D.C.
- ◆ Michael West
- ◆ Elizabeth Zeno
- ◆ Thank You to All Donors!



**Donate to the Swedenborgian Church  
of North America with this QR code.**

# Thank You for Helping!

Thank you to everyone who has contributed their time and talents to making our convention a success:

## THE PLANNING COMMITTEE:

- |                        |                         |
|------------------------|-------------------------|
| ◆ Rudy Caseres         | ◆ Rev. Dr. Jim Lawrence |
| ◆ Karen Conger         | ◆ Rev. Junchol Lee      |
| ◆ Pastor Paul Deming   | ◆ Jennifer Lindsay      |
| ◆ Dr. Rebecca Esterson | ◆ Jackie Shihadeh       |
| ◆ Kurt Fekete          | ◆ Rev. Rich Tafel       |
| ◆ Beki Greenwood       |                         |

## SPECIAL THANKS TO:

- |   |                         |
|---|-------------------------|
| ◆ Rev. Kevin Baxter                       | ◆ Rev. Renée Machiniak  |
| ◆ Rev. Kit Billings                       | ◆ B.J. Neuenfeldt       |
| ◆ The Center for<br>Swedenborgian Studies | ◆ Heather Oelker        |
| ◆ Mary Graves                             | ◆ Angela Sbrocco        |
| ◆ Nancy Leras                             | ◆ Dr. Emily Tergliafera |

# Maps and Addresses

## University Place Hotel & Conference Center

*310 SW Lincoln St. Portland, Oregon*

### 1ST FLOOR

- ♦ Willamette Falls Ballroom
- ♦ Crater Lake Room
- ♦ Coos Bay Room
- ♦ Astoria Room
- ♦ Pool Courtyard
- ♦ Hotel Dining Area

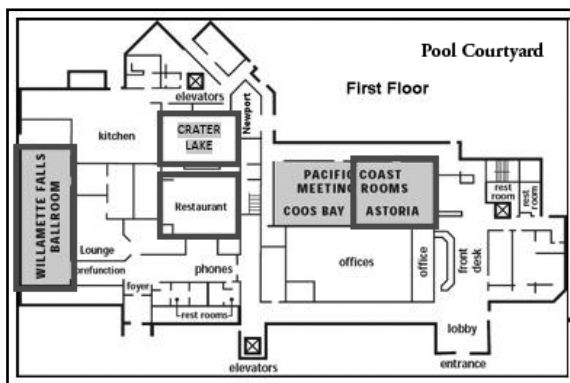

### 2ND FLOOR

- ♦ Columbia Falls Ballroom
- ♦ Pyramid Lake Room

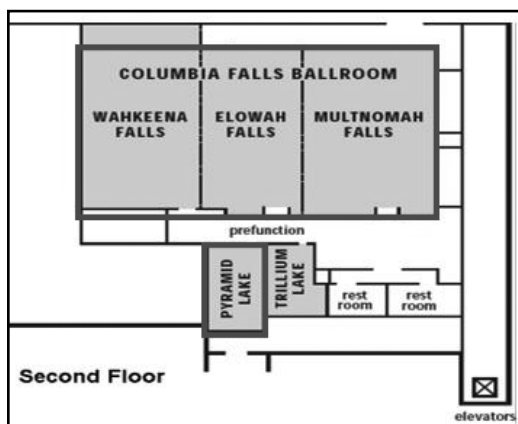

### RECREATION CENTER

- ♦ *1800 SW 6th Ave.*  
Indoor pool facilities,  
gym, recreational  
facilities

### OUTING OPTIONS

- ♦ **International Rose Test Garden**  
*400 SW Kingston Ave.*
- ♦ **Pittock Mansion**  
*3229 NW Pittock Dr.*
- ♦ **Powell's City of Books**  
*1005 W. Burnside St.*

### ORDINATION

- ♦ **St. James Lutheran Church**  
*1315 SW Park Ave.*

# Celebrants of Years of Service in Ministry

<b>10 Years</b> .....	Rev. Julie Conaron
	Rev. Carla Friedrich
	Rev. Doug Moss
<b>20 Years</b> .....	Rev. Sage Cole
<b>25 Years</b> .....	Rev. Solomon Youngmin Kim
	Rev. Junchol Lee
<b>30 Years</b> .....	Rev. Kit Billings
	Rev. Kin'itchi Kuniyeda
	Rev. Renée Machiniak
<b>35 Years</b> .....	Rev. Dr. Wilma Wake
<b>40 Years</b> .....	Rev. Kenneth Turley
<b>45 Years</b> .....	Rev. Sue Turley
	Rev. Gladys Wheaton
<b>60 Years</b> .....	Rev. Randy Laakko



**[www.swedenborg.org](http://www.swedenborg.org)**

**Printed by [www.cranberryprintmarketing.com](http://www.cranberryprintmarketing.com)**